

ULINE

HEAVY-DUTY STEEL SHELVING

1-800-295-5510
uline.com

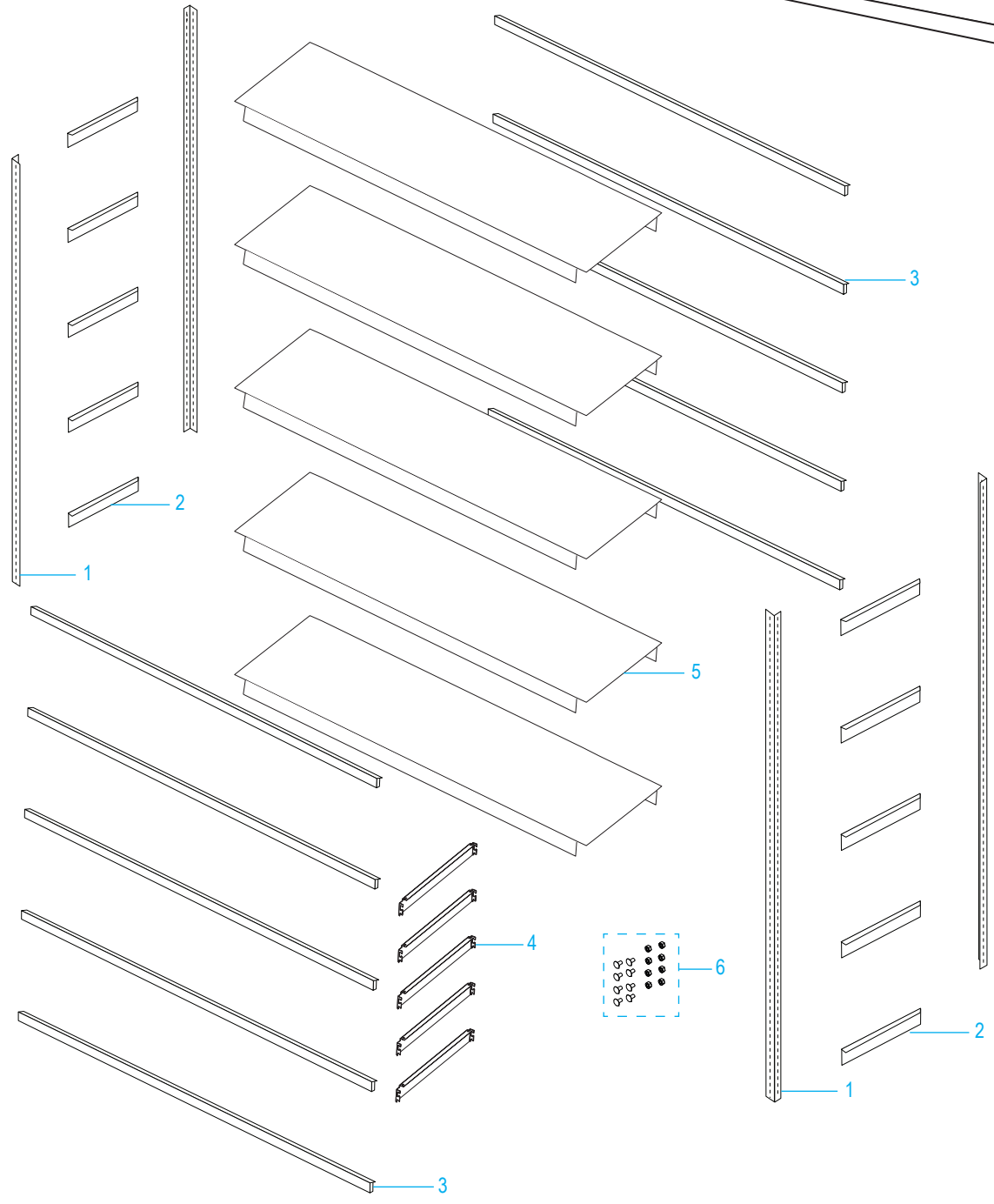
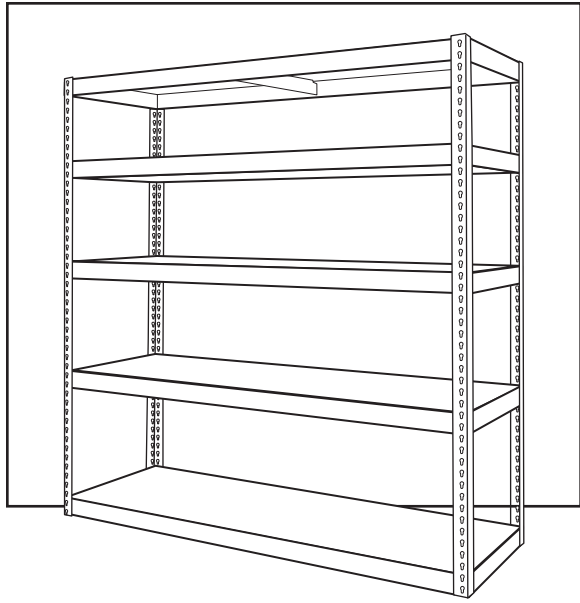

REPLACEMENT PARTS

#	DESCRIPTION	QTY.	ULINE PART NO.	MFG. PART NO.
1	72" Upright Post	4	H-1523-POST	-----
1	84" Upright Post	4	H-1060-POST	-----
1	96" Upright Post	4	H-1894-POST	-----
2	18" Side Support	1	H-1527-BM18	-----
2	24" Side Support	1	H-1061-LRA24	-----
2	36" Side Support	1	H-2188-LRA36	-----
3	36" Front/Back Support	1	H-2188-LRA36	-----
3	48" Front/Back Support	1	H-1060-LRA48	-----
3	60" Front/Back Support	-----	-----	-----
3	72" Front/Back Support	1	H-1528-BEAM	-----
3	96" Front/Back Support	1	H-1897-BEAM	-----
4	18" Center Shelf Support	1	H-1966-CTR	-----
4	24" Center Shelf Support	1	H-1060-CTR	-----
4	36" Center Shelf Support	1	H-2192-CTR	-----
5	36 x 18" Steel Shelf	1*	H-3911-ADD	-----
5	36 x 24" Steel Shelf	1*	H-4857-ADD	-----
5	48 x 18" Steel Shelf	1*	H-3912-ADD	-----
5	48 x 24" Steel Shelf	1*	H-3913-ADD	-----
5	60 x 24" Steel Shelf	1*	H-4862-ADD	-----
5	60 x 36" Steel Shelf	1*	H-5444-ADD	-----
5	72 x 18" Steel Shelf	1*	H-5445-ADD	-----
5	72 x 24" Steel Shelf	1*	H-3914-ADD	-----
5	72 x 36" Steel Shelf	1*	H-3915-ADD	-----
5	96 x 24" Steel Shelf	1**	H-7432-ADD	-----
6	Hardware Pack (includes 8 nuts and 8 bolts)	1	H-6019	-----

* Each shelf includes 2 side supports, 2 front/back supports, center shelf supports needed for each specific size, 2 nuts and 2 bolts.

** Each shelf includes 2 side supports, 2 front/back supports, center shelf supports needed for each specific size, 3 nuts and 3 bolts.

ULINE

**ESTANTERÍA DE
ACERO PARA
USO PESADO**

800-295-5510

uline.mx

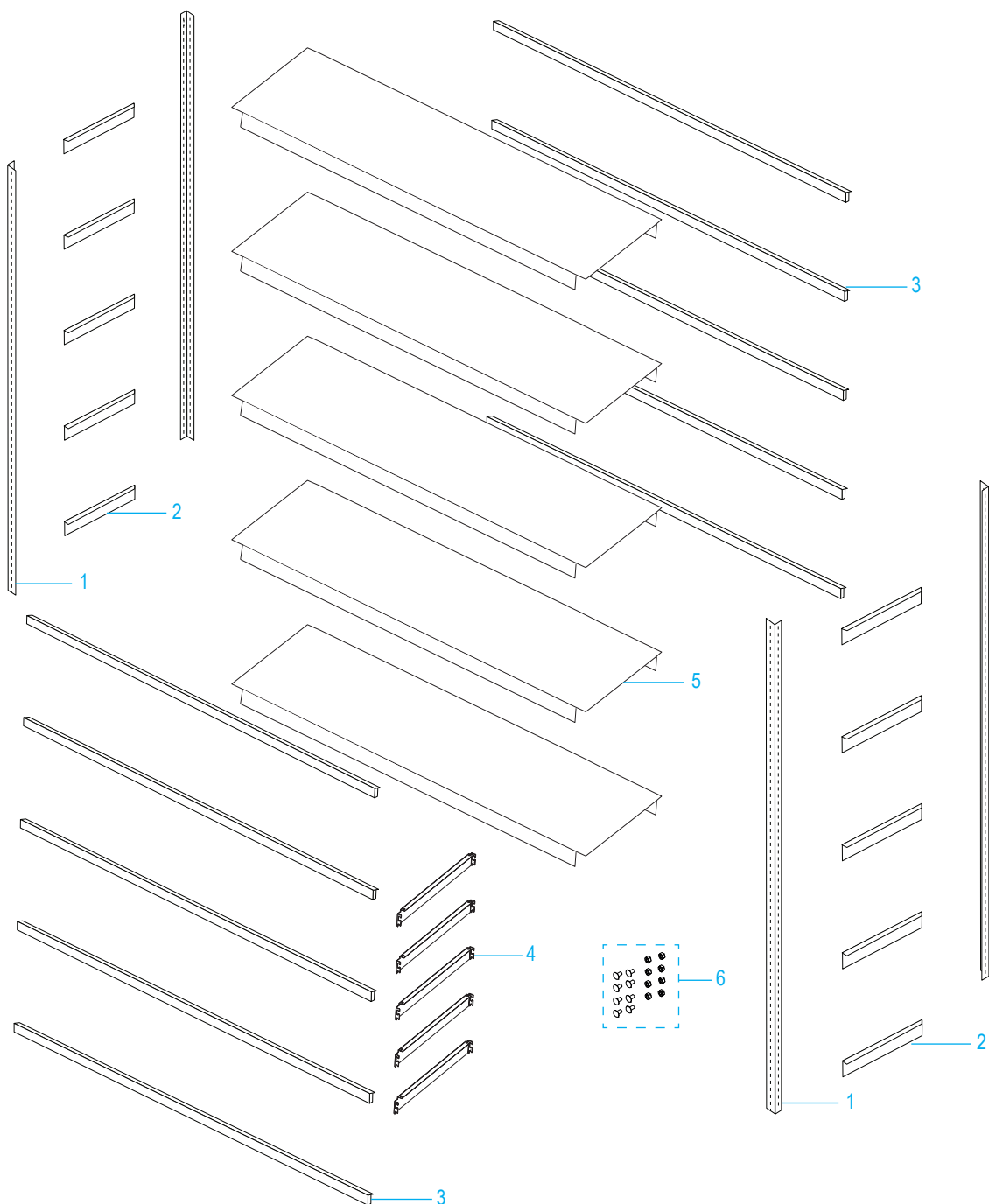

PARTES DE REPUESTO

#	DESCRIPCIÓN	CANT.	NO. DE PARTE DE ULINE	NO. DE PARTE DEL FABRICANTE
1	Poste Vertical de 1.83 m (72")	4	H-1523-POST	-----
1	Poste Vertical de 2.14 m (84")	4	H-1060-POST	-----
1	Poste Vertical de 2.4 m (96")	4	H-1894-POST	-----
2	Soporte Lateral de 45.7 cm (18")	1	H-1527-BM18	-----
2	Soporte Lateral de 61 cm (24")	1	H-1061-LRA24	-----
2	Soporte Lateral de 91.4 cm (36")	1	H-2188-LRA36	-----
3	Soporte Frontal/Posterior de 91.4 cm (36")	1	H-2188-LRA36	-----
3	Soporte Frontal/Posterior de 1.2 m (48")	1	H-1060-LRA48	-----
3	Soporte Frontal/Posterior de 1.5 m (60")	-----	-----	-----
3	Soporte Frontal/Posterior de 1.8 m (72")	1	H-1528-BEAM	-----
3	Soporte Frontal/Posterior de 2.4 m (96")	1	H-1897-BEAM	-----
4	Soporte Central de Repisa de 45.7 cm (18")	1	H-1966-CTR	-----
4	Soporte Central de Repisa de 61 cm (24")	1	H-1060-CTR	-----
4	Soporte Central de Repisa de 91.4 cm (36")	1	H-2192-CTR	-----
5	Repisa de Acero de 91.4 x 45.7 cm (36 x 18")	1*	H-3911-ADD	-----
5	Repisa de Acero de 91.4 x 61 cm (36 x 24")	1*	H-4857-ADD	-----
5	Repisa de Acero de 1.2 m x 45.7 cm (48 x 18")	1*	H-3912-ADD	-----
5	Repisa de Acero de 1.2 m x 61 cm (48 x 24")	1*	H-3913-ADD	-----
5	Repisa de Acero de 1.5 m x 61 cm (60 x 24")	1*	H-4862-ADD	-----
5	Repisa de Acero de 1.5 m x 91.4 cm (60 x 36")	1*	H-5444-ADD	-----
5	Repisa de Acero de 1.8 m x 45.7 cm (72 x 18")	1*	H-5445-ADD	-----
5	Repisa de Acero de 1.8 m x 61 cm (72 x 24")	1*	H-3914-ADD	-----
5	Repisa de Acero de 1.8 m x 91.4 cm (72 x 36")	1*	H-3915-ADD	-----
5	Repisa de Acero de 2.4 m x 61 cm (96 x 24")	1**	H-1897-ADD	-----
6	Paquete de Tornillería (incluye 8 tuercas y 8 pernos)	1	H-6019	-----

* Cada repisa incluye 2 soportes laterales, 2 soportes frontales/posteriores, los soportes de las repisas centrales necesarios para cada tamaño específico, 2 tuercas y 2 pernos.

** Cada repisa incluye 2 soportes laterales, 2 soportes frontales/posteriores, los soportes de las repisas centrales necesarios para cada tamaño específico, 3 tuercas y 3 pernos.

ULINE

**RAYONNAGE EN
ACIER ROBUSTE**

1-800-295-5510

uline.ca

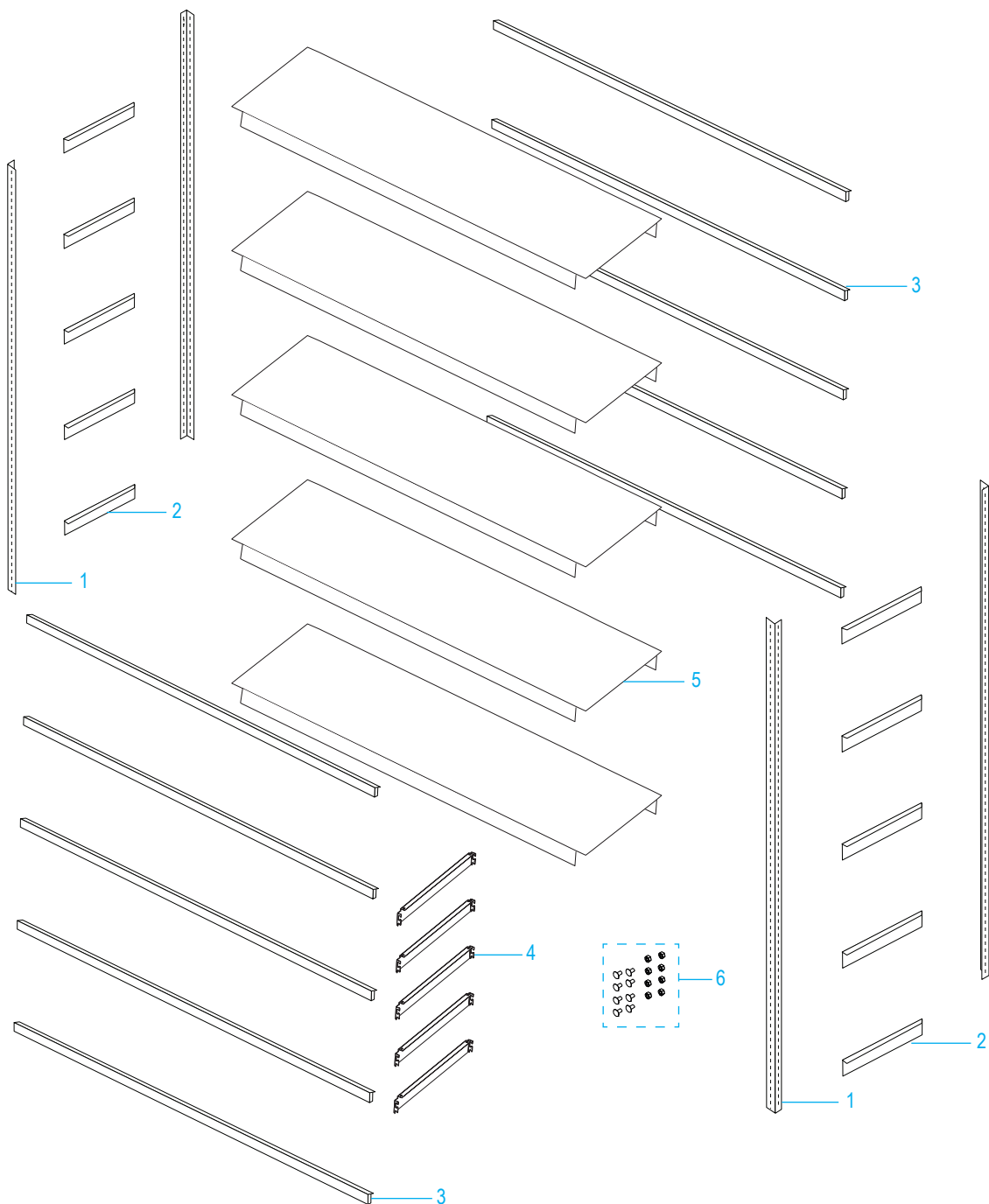
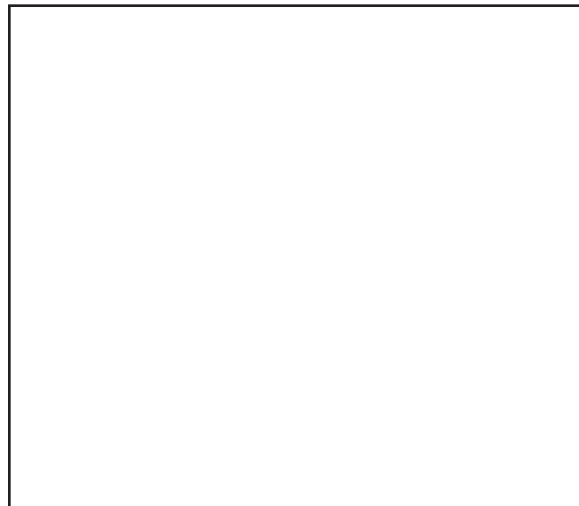

PIÈCES DE RECHANGE

#	DESCRIPTION	QTÉ	RÉF. ULINE	RÉF. DU FABRICANT
1	Montant vertical de 1,8 m (72 po)	4	H-1523-POST	-----
1	Montant vertical de 2,1 m (84 po)	4	H-1060-POST	-----
1	Montant vertical de 2,4 m (96 po)	4	H-1894-POST	-----
2	Support latéral de 45,7 cm (18 po)	1	H-1527-BM18	-----
2	Support latéral de 61 cm (24 po)	1	H-1061-LRA24	-----
2	Support latéral de 91,4 cm (36 po)	1	H-2188-LRA36	-----
3	Support avant/arrière de 91,4 cm (36 po)	1	H-2188-LRA36	-----
3	Support avant/arrière de 1,2 m (48 po)	1	H-1060-LRA48	-----
3	Support avant/arrière de 1,5 m (60 po)	-----	-----	-----
3	Support avant/arrière de 1,8 m (72 po)	1	H-1528-BEAM	-----
3	Support avant/arrière de 2,4 m (96 po)	1	H-1897-BEAM	-----
4	Support central de tablette de 45,7 cm (18 po)	1	H-1966-CTR	-----
4	Support central de tablette de 61 cm (24 po)	1	H-1060-CTR	-----
4	Support central de tablette de 91,4 cm (36 po)	1	H-2192-CTR	-----
5	Tablette en acier de 91,4 x 45,7 cm (36 x 18 po)	1*	H-3911-ADD	-----
5	Tablette en acier de 91,4 x 61 cm (36 x 24 po)	1*	H-4857-ADD	-----
5	Tablette en acier de 1,2 m x 45,7 cm (48 x 18 po)	1*	H-3912-ADD	-----
5	Tablette en acier de 1,2 m x 61 cm (48 x 24 po)	1*	H-3913-ADD	-----
5	Tablette en acier de 1,5 m x 61 cm (60 x 24 po)	1*	H-4862-ADD	-----
5	Tablette en acier de 1,5 m x 91,4 cm (60 x 36 po)	1*	H-5444-ADD	-----
5	Tablette en acier de 1,8 m x 45,7 cm (72 x 18 po)	1*	H-5445-ADD	-----
5	Tablette en acier de 1,8 m x 61 cm (72 x 24 po)	1*	H-3914-ADD	-----
5	Tablette en acier de 1,8 m x 91,4 cm (72 x 36 po)	1*	H-3915-ADD	-----
5	Tablette en acier de 2,4 m x 61 cm (96 x 24 po)	1**	H-7432-ADD	-----
6	Ensemble du matériel (comprend 8 écrous et 8 boulons)	1	H-6019	-----

* Chaque tablette comprend 2 supports latéraux, 2 supports avant/arrière, les supports centraux de tablette convenant à la taille spécifique, 2 écrous et 2 boulons.

** Chaque tablette comprend 2 supports latéraux, 2 supports avant/arrière, les supports centraux de tablette convenant à la taille spécifique, 3 écrous et 3 boulons.